



*jordan fishwick*

6 Hunters Mews, Wilmslow, SK9 2AR  
PCM £3,250 PCM





## Hunters Mews Cheshire SK9 2AR

£3,250 PCM



AVAILABLE MID APRIL PART FURNISHED - VIEWING RECOMMENDED

Four double bedroom detached on this attractive quiet cul de sac within walking distance of Wilmslow town centre and the train station and with good access to the A34 and Manchester International Airport .

Entrance hall with large cloakroom, downstairs toilet, family room, large lounge with gas fire and doors to dining room, fitted kitchen, utility room.

To the first floor master bedroom with fitted wardrobes and en suite bathroom, 3 further double bedrooms, bathroom with jacuzzi bath and separate shower.

Double garage, large patio and fully enclosed rear garden.

Contact Wilmslow 01625 536300 £3250.00pcm

EPC D

COUNCIL TAX G





- EXCELLENT LOCATION
- WALKING DISTANCE OF WILMSLOW AND TRAIN STATION
- DOUBLE GARAGE
- ENCLOSED REAR GARDEN
- COUNCIL TAX G



Energy Efficiency Rating		
	Current	Potential
Very energy efficient - lower running costs		
(92 plus) A		
(81-91) B		
(69-80) C		75
(55-68) D	67	
(39-54) E		
(21-38) F		
(1-20) G		
Not energy efficient - higher running costs		
England & Wales		EU Directive 2002/91/EC 

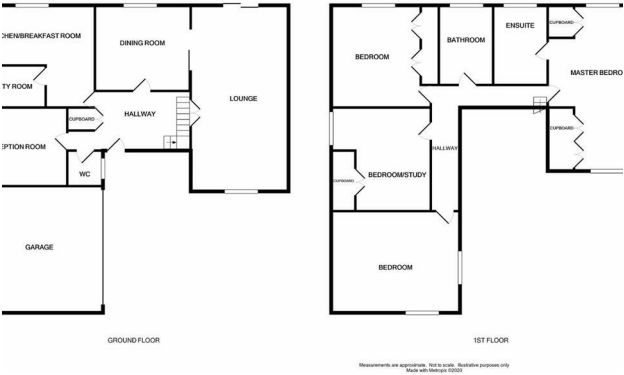



These particulars are believed to be accurate but they are not guaranteed and do not form a contract. Neither Jordan Fishwick nor the vendor or lessor accept any responsibility in respect of these particulars, which are not intended to be statements or representations of fact and any intending purchaser or lessee must satisfy himself by inspection or otherwise as to the correctness of each of the statements contained in these particulars. Any floorplans on this brochure are for illustrative purposes only and are not necessarily to scale.

Offices at: Chorlton, Didsbury, Disley, Hale, Glossop, Macclesfield, Manchester Deansgate, Manchester Whitworth Street, New Mills, Sale, Wilmslow and Withington

01625 536300

wilmslow@jordanfishwick.co.uk  
www.jordanfishwick.co.uk